

ELDER TOOLS INTERNATIONAL

P.O. Box 111 Tel: 361-275-5600
 Cuero, TX 77954 Fax: 361-275-6700
 Web Site: <http://www.eldertools.com>
 Email: oiltools@eldertools.com



Flow Control
 Profile Landing Nipples

DESCRIPTION:

Profile Landing Nipples allow various wireline flow control devices to be placed at predetermined locations in the production tubing. The location and number of Profile Landing Nipples should be carefully considered to allow maximum versatility.

Profile Landing Nipples are divided into two groups. 'Selective' nipples include type 'ETI-F' and type 'ETI-X' profiles. Any number of the same type and size selective nipples can be installed in the tubing. 'Non-Selective' or 'No-Go' nipples include type 'ETI-R', type 'ETI-XN' and type 'ETI-N' profiles and have a slightly restricted 'No-Go' at bottom to keep wireline tools from exiting the tubing. Non-selective nipples are used alone or as the bottom nipple with a series of compatible selective nipples.

APPLICATIONS:

Profile landing nipples may be used for the following operations:

- Land blanking plugs to shut well in or test tubing.
- Land velocity type safety valves (SSCSV).
- Land equalizing check valves.
- Land circulating blanking plugs.
- Land chokes to reduce surface flowing pressure.
- Land instrument hangers with geophysical devices such as pressure and temperature recorders.

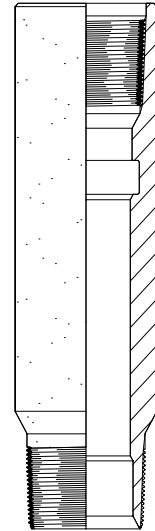

'ETI-F'
 Selective Nipple

FEATURES:

- Maximum versatility reduces completion and production costs.
- Honed internal bores increase seal performance.
- Large bores provide maximum flow area.
- All premium threads available.
- Corrosion resistant materials available.

AVAILABILITY:

Tubing Size	Profile Landing Nipples						
	Selective Profiles		Nipple OD*	Non-Selective Profiles			
	Seal Bore ID			Seal Bore ID		No-Go ID	
	'ETI-F'	'ETI-X'		'ETI-R'	'ETI-N'	'ETI-XN'	
1.900	1.500		2.110	1.500			1.447
		1.500	2.200		1.500		1.448
2.063	1.562		2.325	1.562			1.510
	1.625			1.625			1.572
		1.625	2.620		1.625		1.536
2.375	1.781		3.063	1.781			1.728
	1.812			1.812			1.760
	1.875			1.875			1.822
		1.875	2.730		1.875		1.791
2.875	2.250		3.668	2.250			2.197
	2.312			2.312			2.260
			2.313	3.200		2.313	
3.500	2.562		4.500	2.562			2.443
	2.750			2.750			2.697
	2.812			2.812			2.759
		2.750	3.900		2.750		2.638
		2.813			2.813		2.666
4.000		3.313	5.000			3.313	3.125
4.500	3.688		5.563	3.688			3.625
	3.812			3.812			3.759
		3.813			3.813		3.725

Nipples are manufactured to tubing joint OD or coupling OD. OD shown is for standard API tubing.

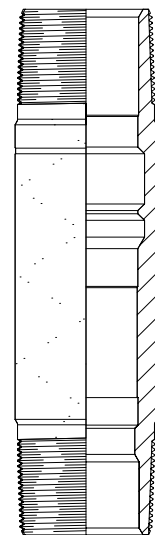

'ETI-XN'
 Non-Selective